

Einschlagdübel

W-ED/S

W-ED

W-ED/A4

W-ED/HCR

13.1

13.2

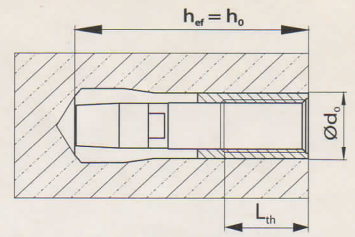

W-ED ...	M	Ød ₀ [mm]	h ₀ [mm]	h _{ef} [mm]	L _{th} [mm]	T _{inst} [Nm]
M5x25*	M5	8	25	25	10	3
M6x30	M6	8	30	30	13	4
M8x30	M8	10	30	30	13	8
M8x40	M8	10	40	40	20	8
M10x40	M10	12	40	40	15	15
M12x50	M12	15	50	50	18	35
M12/AD 16*	M12	16	50	50	18	35
M12x80	M12	15	80	80	45	35
M16x65	M16	20	65	65	23	60
M16x80	M16	20	80	80	38	60
M20x80	M20	25	80	80	34	120

*) nicht zugelassen / not subject of approval

CE 0756
Werk W1, D
WÜRTH
02
0756-cpd-0007
ETA-02/0044
ETAG 001-4 Option 7
M6 - M20

CE 0756
Werk W1, D
WÜRTH
05
0756-CPD-0077
ETA-05/0120
ETAG 001-6
M6 - M12

CE 0756
Werk W1, D
WÜRTH
03
0756-cpd-0015
ETA-03/0051
ETAG 001-4 Option 7
M6 A4 - M20 A4
M6 HCR - M10 HCR

CE 0756
Werk W1, D
WÜRTH
05
0756-CPD-0079
ETA-05/0121
ETAG 001-6
M6 A4 - M12 A4
M6 HCR - M10 HCR

Dübel entspricht den
VDS-Richtlinien
M8 - M12
M8 - M12 A4
M8-M10 HCR

Brandschutz-
geprüft
M6 - M20
FM
M10 - M20
EDELSTAHL
Rost
frei
HCR

Original \diamond E

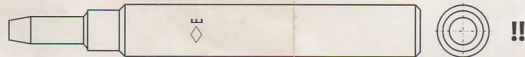

Original \diamond ME

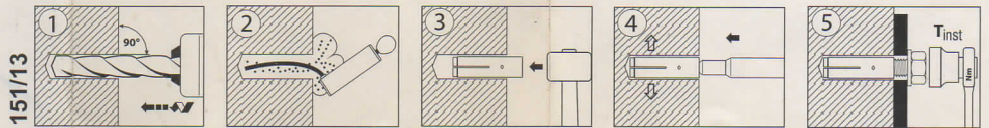

151/13